

92-B-61 - SPEEDLINE System Data Sheet - Version V1 (24-10-23)

SPEEDLINE 92mm 'C' Stud Partition @600mm Ctrs,
with 2x BG Gyproc 12.5mm FireLine each side

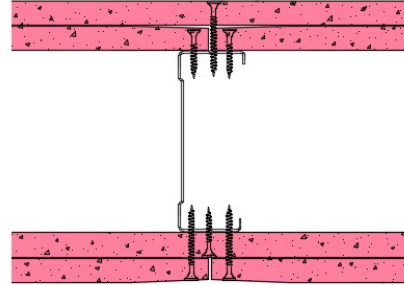

System Performance Breakdown

Fire Resistance:

BS476 Part 22:1987:

Test Ref & Date or Applied Ref & Report:

Max Height:

Thickness:

Duty Grade: BS 5234: Part 2:1992:

Sound Insulation:

120/120 Minutes (Integrity/Insulation).

BTC 17442F - BRE Report P102396-1011A

Refer to Speedline Specification Clause

142 mm. (At Base Track, Excluding Finishes)

Severe - Annexes A-F

47 R_w dB, Date Tested or Assessed Against - 70-B-61

Test Code:
H17498AA
Test Date:
25/07/2011

Freq. Hz	R dB
50	26.6
63	16.8
80	11.7
100	20.7
125	22.8
160	31.7
200	38.7
250	39.1
315	42.3
400	45.7
500	49.1
630	51.2
800	54.8
1 000	56.4
1 250	58.0
1 600	59.7
2 000	53.7
2 500	44.6
3 150	46.3
4 000	50.2
5 000	53.1
6 300	
8 000	
10 000	

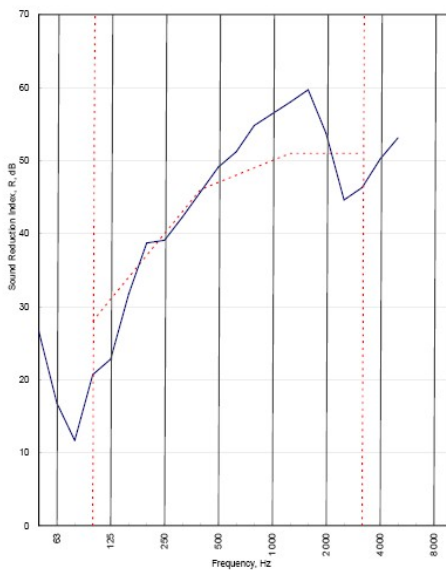

Rating according to BS EN ISO 717-1:1997
 $R_w (C;Ctr) = 47 (-3;-9) \text{ dB}$
 Max dev. 8.2 dB at 125 Hz

Evaluation based on laboratory measurement results obtained by an engineering method:	$C_{50-3150} = -6 \text{ dB}$	$C_{50-5000} = -5 \text{ dB}$	$C_{100-5000} = -2 \text{ dB}$
	$C_{5-50-3150} = -16 \text{ dB}$	$C_{5-50-5000} = -16 \text{ dB}$	$C_{5-100-5000} = -9 \text{ dB}$

TESTED AT ONE OF THE UKAS ACCREDITED LABORATORIES BELOW

- B.T.C (H-Ref on Graph)
- B.R.E
- AIRO
- S.R.L

Customer: Metsec plc Hepsec Division



BTC 17498A: Page 8 of 10

SPEEDLINE Drywall Systems, Adsetts House, 16 Europa View, Sheffield Business Park, Sheffield, S9 1XH.

Tel: 0114 231 8030.

Email: enquiries@speedlinedrywall.co.uk

(As per the requirements set out in ISO/IEC 17025:2017 regarding test data the results stated have been carried out by voestalpine Metsec plc as part of the contract to supply Speedline Metal Sections to SIG Plc)